



ENIB Co., Ltd.

GCA MANUAL VALVE

GENERAL CHEMICAL APPLICATION- PIPE CONNECTION TYPE-HIGH FLOW

OVERVIEW

GCA Manual valve is made only of fluoropolymer material and is designed to generate optimal performance in handling high-purity chemicals

FEATURES

1. Made only of high-purity Fluoropolymer material and is designed to generate optimal performance in handling high-purity chemicals.
2. Bonnet is screwed onto the body(All-in-one assembly) to prevent valve deformation and improve airtightness.
3. The Bonnet Lock and fitting Nut Lock stabilize and prevent loosening of valve components adding additional safety.
4. Visually identifiable on and off indicator for precise valve operation

TECHNICAL DATA

Actuator Type	Manual Handle Operation
Connection Type	ENIB Pipe Connection
Configuration	2-Way Flow / Orifice

Model Number	Size	Orifice	Cv	Port Configuration
GMV-P-40	40A	40.86	38.3	40A Pipe Connection
GMV-P-50	50A	52.5	51.1	50A Pipe Connection

Operating Temperature	Operating Pressure
0 ~ 90 °C	9kg/cm ² (0.9Mpa)
90 ~ 120 °C	7kg/cm ² (0.7Mpa)

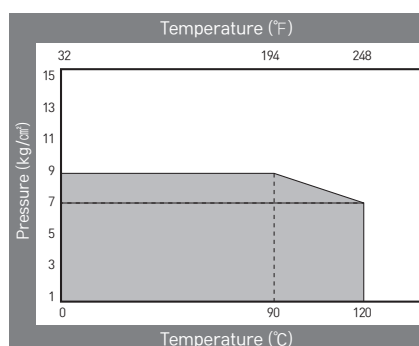

High Flow Pipe Type Size
40A, 50A

2-WAY FLOW PATTERNS

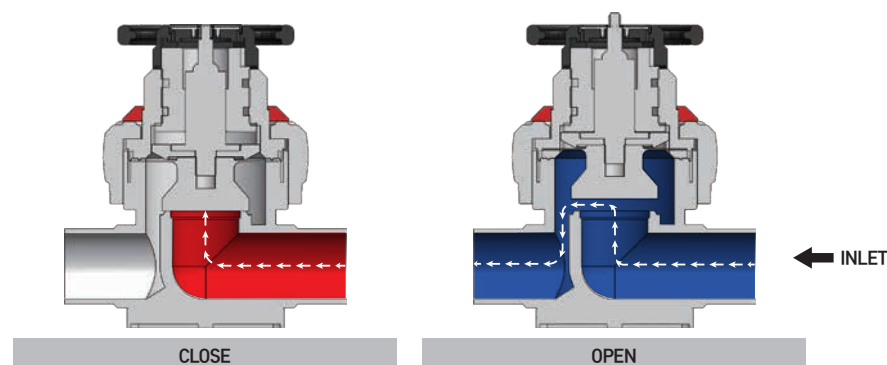

MATERIAL CONSTRUCTION & DIMENSION TABLE

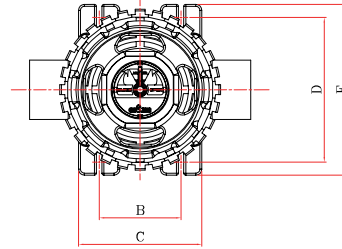
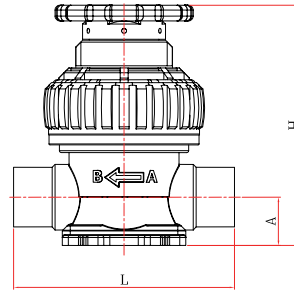
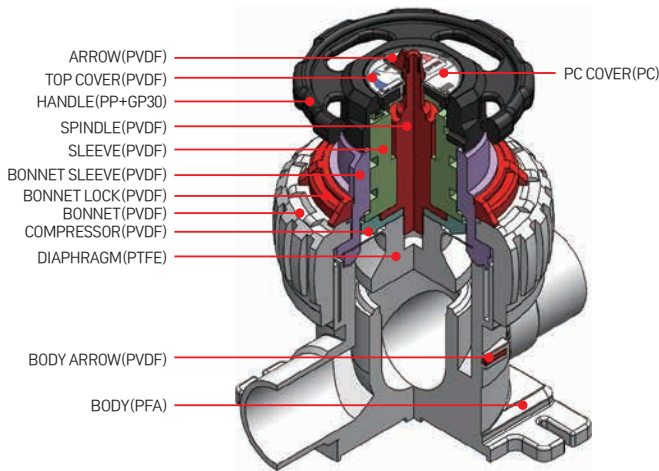

Size	A	H	L	B	C	D	E
40A	1.93"(49mm)	9.49"(241mm)	8.82"(224mm)	3.27"(83mm)	4.92"(125mm)	5.89"(149.5mm)	6.81"(173mm)
50A	1.93"(49mm)	9.49"(241mm)	8.82"(224mm)	3.27"(83mm)	4.92"(125mm)	5.89"(149.5mm)	6.81"(173mm)

HOW TO ORDER

Type	CODE
GCA MANUAL VALVE	GMV
Connection	CODE
PIPE	P
SIZE	CODE
40A	40
50A	50

Example : GMV-P-50

GMV	GCA MANUAL VALVE
P	PIPE
50	50A

“ SMART VALUE OPERATION PRODUCT LINE UP ”

ENIB (Extrusion & Injection, Basic Co., Ltd) Corporate Mission :

ENIB is to become a key provider of safe, high performance, and advanced technology device and components for fluid management systems and applications that meet or exceed the needs and requirements of global customers.

62, BANSAN 2-RO, MUNMAK-EUP, WONJU-SI,
 GANGWON-DO, REPUBLIC OF KOREA
 Customer Service Tel : +82 033-743-9200
 Customer Fax : +82 033-743-9201
www.enib.co.kr